

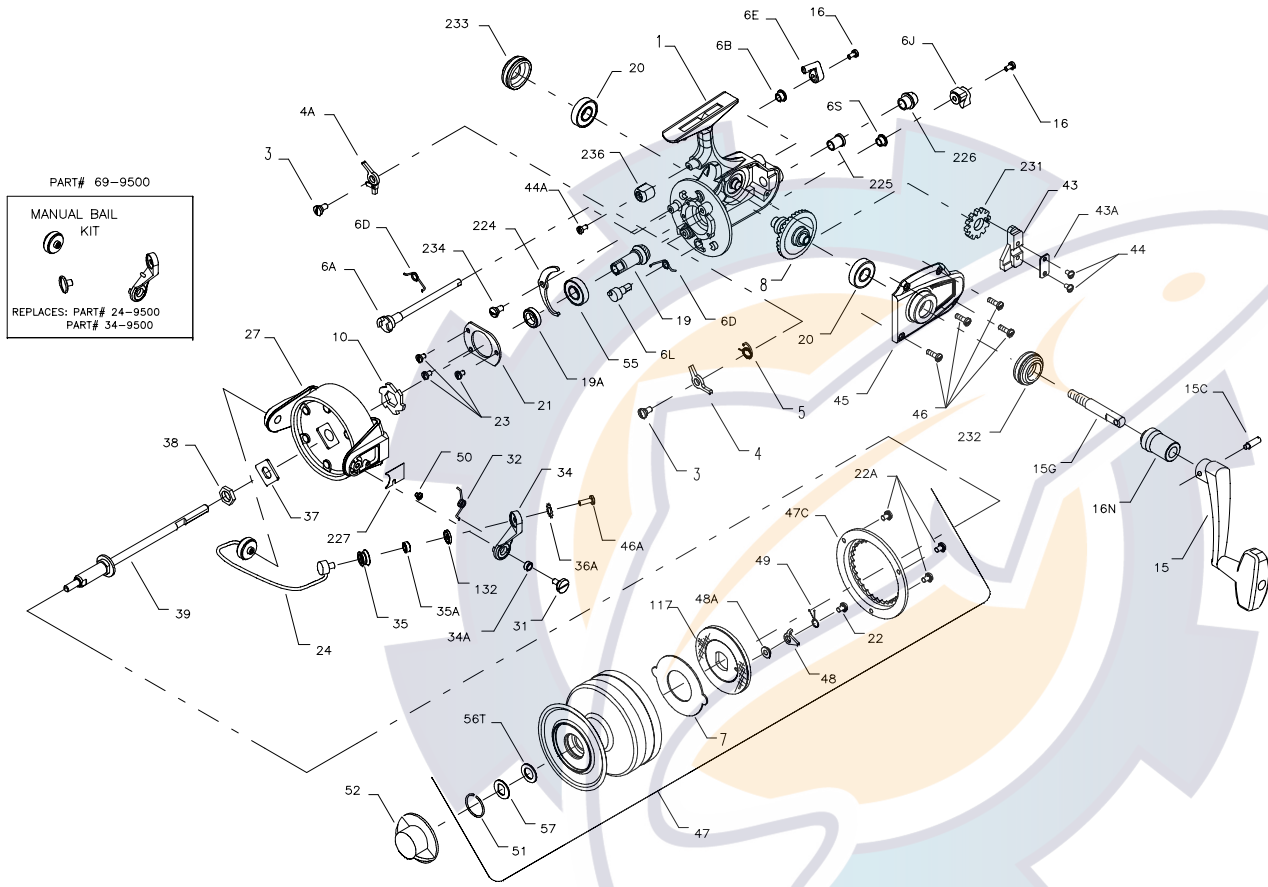

PARTS LIST FOR MODEL 9500SS



| KEY NO. | DESCRIPTION | PART NO. |
|---------|--------------------------------|----------|
| 15 | Handle | 015 750 |
| 15C | Handle Pivot Screw | 015C750 |
| 15G | Handle Pivot | 015G9500 |
| 16 | Eccentric Screw (2 req.) | 016 910 |
| 16N | Collar | 016 9500 |
| 19 | Pinion | 019N9500 |
| 19A | Pinion Spacer | 019A9500 |
| 20 | Ball Bearing (2 req.) | 020 704 |
| 21 | Bearing Cover | 021 9500 |
| 22 | Spool Click Screw | 022 9500 |
| 22A | Drag Cover Screw (3 req.) | 022A9500 |
| 23 | Bearing Cover Screw (3 req.) | 023 750 |
| 24 | Bail Wire | 024 9500 |
| 27 | Rotor | 027 9500 |
| 31 | Bail Arm Screw | 031 750 |
| 32 | Bail Arm Spring | 032 750 |
| 34 | Bail Arm | 034 9500 |
| 34A | Bail Arm Bushing | 034A750 |
| 35 | Line Roller | 035 9500 |
| 35A | Line Roller Bearing | 035A706 |
| 36A | Lock Washer | 036A750 |
| 37 | Rotor Washer | 037 9500 |
| 38 | Rotor Nut | 038 9500 |
| 39 | Spool Shaft | 039 9500 |
| 43 | Spool Block | 043 9500 |
| 43A | Crosswind Block Plate | 043A750 |
| 44 | Crosswind Block Screw (2 req.) | 044 750 |
| 44A | Trip Bumper Screw | 044 750 |
| 45 | Housing Cover | 045 9500 |
| 46 | Housing Cover Screw (4 req.) | 046 9500 |
| 46A | Bail Stud Screw | 046A9500 |
| 47 | Spool (Complete) | 047 9500 |
| 47C | Drag Cover | 047C9500 |
| 48 | Click Tongue | 048 9500 |
| 48A | Click Tongue Washer | 048A9500 |
| 49 | Click Tongue Spring | 049 9500 |
| 50 | Bail Spring Cover Screw | 050 712 |
| 51 | Retaining Ring | 051 704 |
| 52 | Drag Knob | 052 9500 |
| 55 | Ball Bearing | 055 50 |
| 56T | Drag Washer (Teflon®) | 056T704 |
| 57 | Drag Washer Keyed | 057 704 |
| 69 | Manual Bail Kit (Optional) | 069 9500 |
| 117 | Drag Washer/Drive Plate | 117 9500 |
| 132 | Roller Washer | 132 706 |
| 224 | Transfer Lever | 224 750 |
| 225 | Crosswind Shaft Bushing | 225 9500 |
| 226 | Bushing Cap Screw | 226 9500 |
| 227 | Bail Spring Cover | 227 9500 |
| 231 | Crosswind Gear | 231 9500 |
| 232 | Bearing Cover (Open) | 232 750 |
| 233 | Bearing Cover (Closed) | 233 750 |
| 234 | Transfer Lever Screw | 234 750 |
| 236 | Trip Bumper | 236 750 |

| KEY NO. | DESCRIPTION | PART NO. |
|---------|------------------------|-----------|
| 1 | Housing | 001 9500 |
| 3 | Dog Screw (2 req.) | 003 750 |
| 4 | Dog | 004 750 |
| 4A | Silent Dog | 004A750 |
| 5 | Click Dog Spring | 005 704 |
| 6A | Upper Eccentric | 006A750 |
| 6B | Upper Eccentric Liner | 006B750 |
| 6D | Eccentric Spring | 006D710 |
| 6E | Anti-Reverse Lever | 006E750 |
| 6J | Silent Dog Lever | 006J750 |
| 6L | Silent Eccentric | 006L750 |
| 6S | Silent Eccentric Liner | 006B700Z |
| 7 | Metal Drag Washer | 007 004FR |
| 8 | Main Gear | 008N9500 |
| 10 | Ratchet | 010 9500 |